

30-32 The Leas

Westcliff-on-sea, Essex

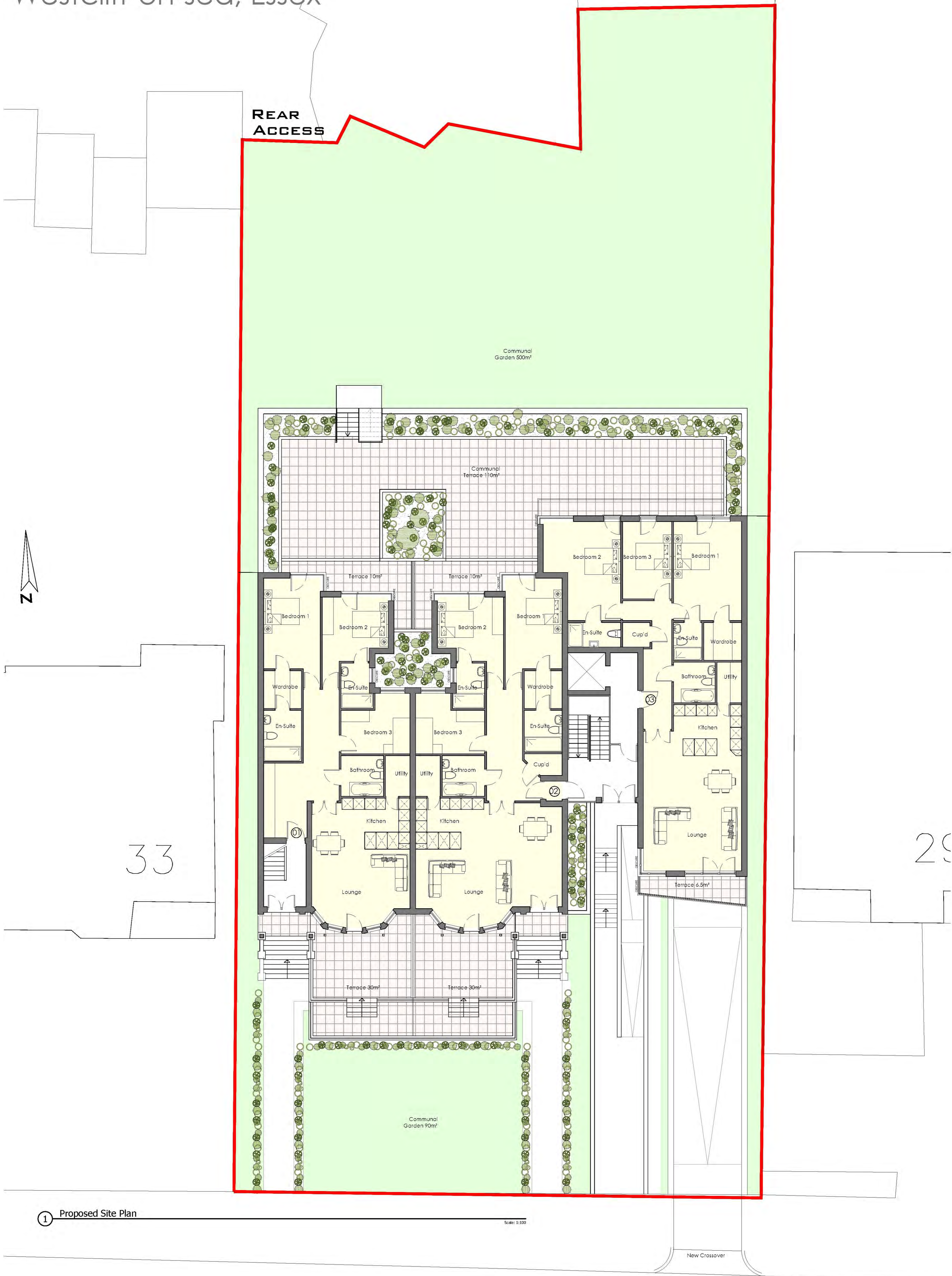

1 Proposed Site Plan

Scale: 1:100

REVISION DATE AMENDMENT
APS DESIGN ASSOCIATES LTD
 ARCHITECTURAL DESIGNERS AND PLANNING CONSULTANTS
 PROJECT STAGE TOWN PLANNING DRAWN BY T.E DATE 17.11.2017
 CLIENT MR. ELMORE
 PROJECT 30-32 THE LEAS
 JOB NO 2566 DRAWING NO 07 REVISION
 DRAWING TITLE Proposed Site Plan SCALE 1:100 @ A1
 The Design Studio 1 Cambridge Road (Rear) Nelson Street Southend-On-Sea Essex SS1 1ET
 Tel: 01702 468 788 - 01702 337328 Email: admin@apsdesignsuk.com design@apsdesignsuk.com planning@apsdesignsuk.com Website: www.apsdesignsuk.com